

Maintenance Extraordinary Enforcement Checklist

Office of Maintenance

FY20

This information checklist should be used as a communication tool for MnDOT and State Patrol, either on site or during the enforcement planning stage.

- Location description of work zone: advance warning to end of zone.
- Time the State Patrol should be on site, placement of patrol vehicle.
- Type of work being done
- Potential hazards
 - Staging of the work zone
 - Work vehicles entering/exiting the zone (i.e.: trucks hauling, maintenance vehicles, etc...)
- Should MSP keep emergency light activated? Headlights? (Consider Ted Foss Move Over Law)
- Should MSP provide passive enforcement (presence) or active enforcement (ticketing)?
 - If MSP tickets, they may need to vacate the work zone to transport individuals to a holding facility in certain situations.
- Is the reduced speed in zone **ADVISORY** or **REGULATORY**?
- Will there be a queue or back up at a certain time?
- Radio frequency for communication / flagger
- If there are any issues or questions, you may contact the District MSP Captain.

Patrol Vehicle Placement

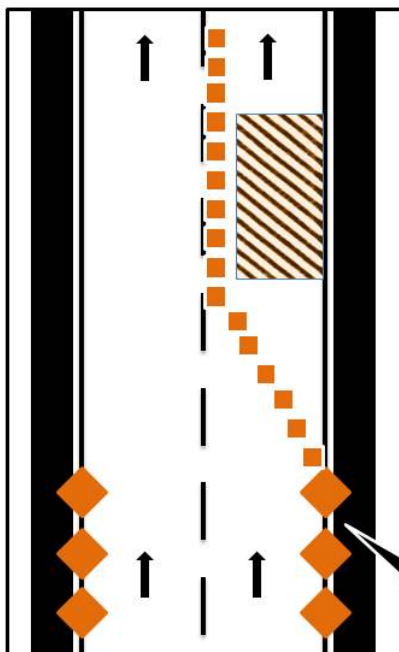

- **BEFORE** the transition.
 - **NOT IN BUFFER**
- On the **SHOULDER** or **MEDIAN**
- Between 2nd and 3rd signs
 - Where we need motorists to pay most attention to what they need to do.

*Please consult with the proper MnDOT contact to verify trooper location

PATROL VEHICLE SHOULD BE HERE